

PLAT OF SURVEY  
-OF-

LOTS 9 AND 10, BLOCK 7, EXCEPT THAT PART OF LOTS 9 AND 10 SOLD TO L.J. WOLFGRAM DESCRIBED AS FOLLOWS: THE SOUTH 45 FEET OF LOT 10 AND THE SOUTH 45 FEET OF THE EAST 14 FEET OF LOT 9, THE PROPERTY HEREIN INTENDED TO BE CONVEYED BEING ALL SITUATED IN BURKE AND CAMPBELL'S VILLAGE OF LYONS IN THE COUNTY OF WALWORTH AND STATE OF WISCONSIN ACCORDING TO A PLAT RECORDED IN THE OFFICE OF THE REGISTER OF DEEDS OF SAID COUNTY.

SURVEY FOR: JOSH PELLA SURVEY ADDRESS: 1522 MILL STREET

NOTE: REFER TO A CURRENT TITLE REPORT FOR EASEMENTS, RESTRICTIONS OR COVENANTS WHICH MAY AFFECT THE USE OF THIS PROPERTY.

NOTE: BUILDING TIES AS SHOWN ARE TO THE SIDING.

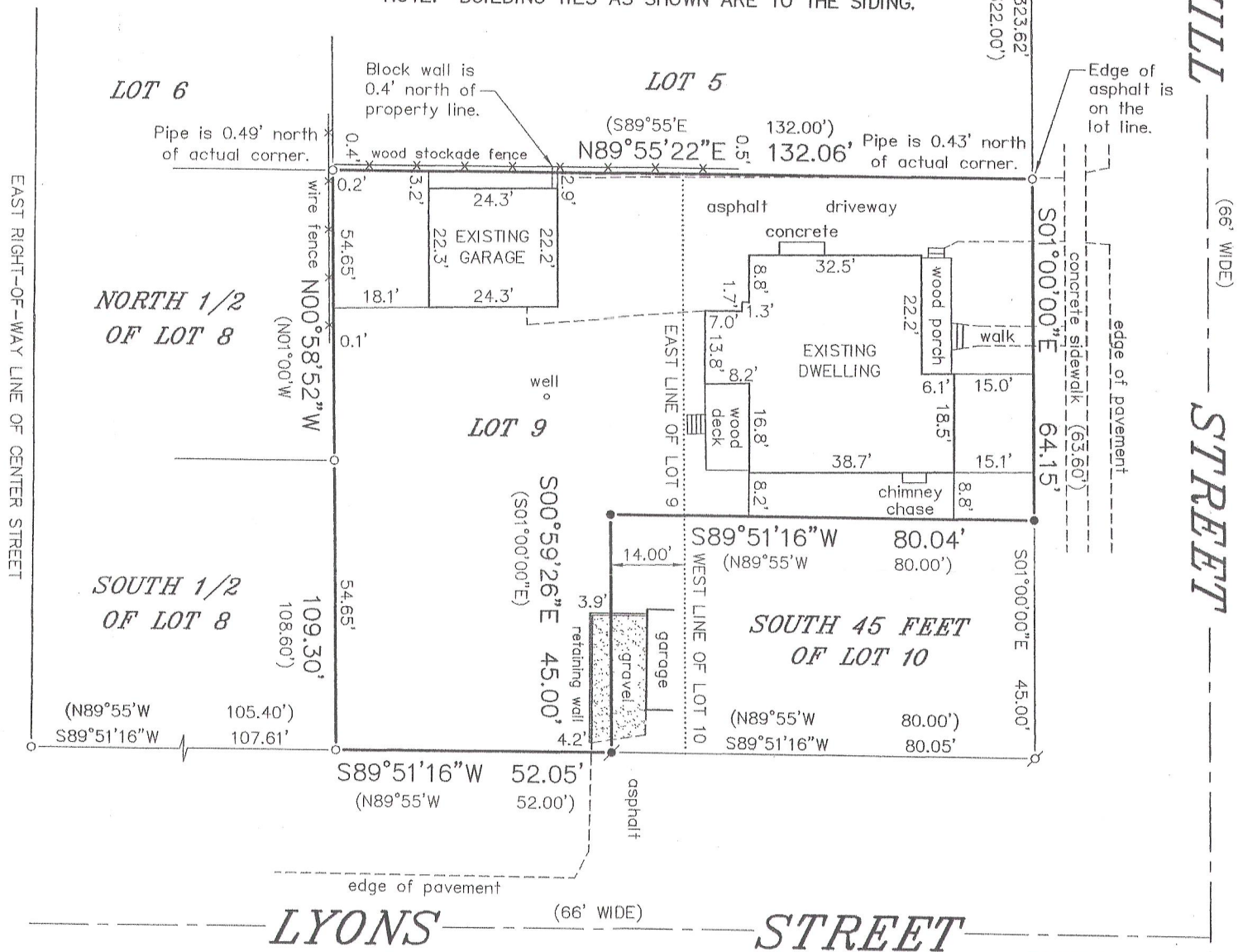

LEGEND

- FOUND IRON PIPE
- ⊕ FOUND IRON BAR
- SET IRON PIPE
- ✦ SET RAILROAD SPIKE
- ( ) RECORDED AS

BEARINGS HEREON RELATE TO THE EAST LINE OF BLOCK 7 OF BURKE & CAMPBELL'S VILLAGE OF LYONS SUBDIVISION. ASSUMED BEARING OF SOUTH 01°00'00" EAST AS PLATTED.

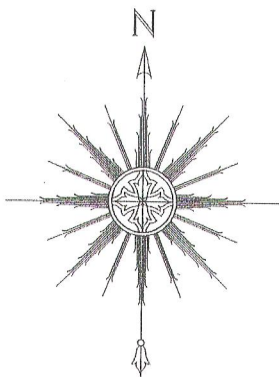

"I HEREBY CERTIFY THAT I HAVE SURVEYED THE ABOVE DESCRIBED PROPERTY AND THAT THE ABOVE MAP IS A CORRECT REPRESENTATION THEREOF AND SHOWS THE SIZE AND LOCATION OF THE PROPERTY, ITS EXTERIOR BOUNDARIES, THE LOCATION OF ALL VISIBLE STRUCTURES AND DIMENSIONS OF ALL PRINCIPAL BUILDINGS THEREON, BOUNDARY FENCES, APPARENT EASEMENTS, ROADWAYS AND ENCROACHMENTS, IF ANY."

"THIS SURVEY IS MADE FOR THE USE OF THE PRESENT OWNERS OF THE PROPERTY, AND THOSE WHO PURCHASE, MORTGAGE, OR GUARANTEE THE TITLE THERETO WITHIN ONE YEAR FROM DATE HEREOF."

**SATTER SURVEYING, LLC**  
LAND SURVEYS, MAPPING AND PLANNING  
272 ORIGIN STREET  
BURLINGTON, WI 53105  
262-661-4239

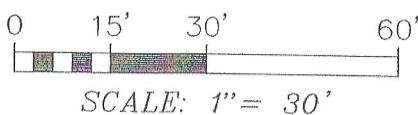

SCALE: 1" = 30'

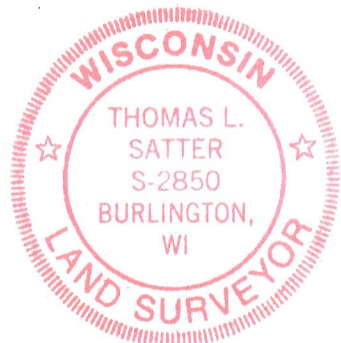
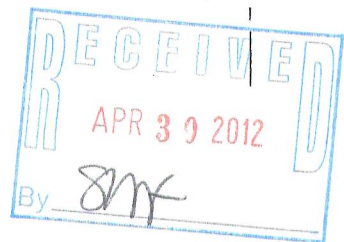

THIS IS NOT AN ORIGINAL PRINT  
UNLESS THIS SEAL IS RED.

*Thomas L. Satter*  
THOMAS L. SATTER S-2850

MARCH 21, 2012  
DATE

031202  
JOB NUMBER

NL-50A

218-1793